

Culinary tourism on the edge of Kali Code: Strategies for the development and empowerment of Kampung Surokarsan

Mutiara Cininta^{1*} , Hari Saptaning Tyas²

¹ Architecture Study Program, Faculty of Engineering, Universitas Atma Jaya Yogyakarta, Indonesia

² Government Science Study Program, STPMD "APMD" Yogyakarta, Indonesia



ARTICLE INFO	ABSTRACT
<p><i>Article history:</i> Received April 27, 2024 Received in revised form May 26, 2024 Accepted June 11, 2024 Available online August 01, 2024</p> <p><i>Keywords:</i> Community empowerment Culinary tourism Urban farming</p> <p>Corresponding author: Mutiara Cininta Architecture Study Program, Faculty of Engineering, Universitas Atma Jaya Yogyakarta, Indonesia Email: mutiara.cininta@uajy.ac.id ORCID: https://orcid.org/0000-0002-3030-5855</p>	<p><i>The government has constructed a robust embankment in Kampung Surokarsan, formerly a landfill, now providing a clearer view of Kali Code's banks. Nevertheless, residents have not yet tapped into the potential of Kali Code's surroundings for public or tourism purposes. In this densely populated area with predominantly self-employment, the "Code Hijau Asri" farmer group in RT 13 and RT 14, RW 04, strives to enhance welfare and income through urban farming. This study aims to devise strategies for structuring culinary tourism in Surokarsan. Primary data from field observations and interviews complement secondary data from a literature review. SWOT analysis guides strategy formulation, emphasizing Strengths and Opportunities, Weaknesses and Opportunities, Strengths and Threats, Weaknesses and Threats. Tourism strategy follows the 5A approaches: Attractions, Activities, Accessibility, Facilities, and Accommodation, which leverage the urban farmer community and residents skilled in culinary businesses and Brazilian spinach cultivation. The formulated strategy focuses on the legibility of the area's entrance, zoning activities division, and showcasing attractions such as sunset views and urban village ambience.</i></p>

Introduction

Kampung Surokarsan is a densely populated settlement in *Kecamatan Mergangsan, Kelurahan Wirogunan*, which Kali Code passes on the west side. This area, especially RW 04, was once categorized as slum housing ([Sekretaris Daerah Kota Yogyakarta 2021](#)). Slums based on the Regulation of the Minister of Public Works and Public Housing Number 14/PRT/2018 ([Kusumosusanto et al. 2022](#)) can be defined as housing that has decreased the quality of its function as a residential place. Slums are uninhabitable settlements due to the irregularity of buildings, high density of buildings, and the quality of buildings and infrastructure that do not meet the requirements.

Kampung Surokarsan has several vulnerabilities in infrastructure and resources. The land in this village belongs to the palace or *keraton*. Another vulnerability is the threat of lava flooding. In addition, in the past, this area was used to pile up garbage and gradually became a place to live. As a result, the fulfilment of water needs depends on PDAM (Local Water Supply Company) due to the difficulty of digging wells where water is suitable for consumption in this area. This condition adds to the significant expenditure of citizens on basic needs. Another vulnerability is that low-income families dominate human resources. Residents have various occupations, such as construction labourers, self-employed people, and contract workers. Therefore, there is a need for motivation

and encouragement to get alternative income to empower the community (Tyas 2023).

Efforts to alleviate slums in urban areas can begin with the transformation of previously slum areas into productive areas, as well as creating an environment that has added economic value for people with low incomes and contributes to environmental conservation, thus leading to the formation of sustainable cities (Mahagarmitha 2018; Hasibuan et al. 2021; Khansyah 2024). Some of the urban approach efforts that can be replicated in slums are urban farming, urban forests, and urban communities based on integrated tourism (Erviyanto and Felasari 2019; Wulandari and Pasaribu 2023). In addition, unorganized slum areas can be creatively transformed into tourist villages. The establishment of tourist villages can be implemented by taking into account the involvement of various parties such as the government from the RT, RW, Kelurahan, Kecamatan, and city governments, as well as the community, youth, village communities, and the need for assistance from the initiator to develop creative ideas (Resa, Saam, and Tarumun 2017; Ulwiyah 2023).

Table 1. Originality of the research

Name (Year)	Title	Research results
(Zahran and Hermansyah 2022)	<i>Pemberdayaan Masyarakat di Kampung Wisata Berkelir Kelurahan Babakan Kecamatan Tangerang, Kota Tangerang</i>	The results of empowering the Kampung Wisata Berkelir based on culinary stalls have a positive economic impact on the residents. In addition, the government provides support by providing semi-permanent culinary kiosks on the land of the former Cisadane River bank park free of charge. The accommodating support was enthusiastically received by the residents, especially the members of the Culinary Stall Programme, making this empowerment programme a success.

Name (Year)	Title	Research results
(Sulistiyani and Mentayani 2022)	<i>Penataan Kawasan Tepian Sungai Sebagai Ruang Terbuka di Murung Kenanga, Martapura</i>	The Murung Kenanga Riverfront area has the potential to be developed into an RTH (open green space) as well as a socialization space for the community. The application of structuring is implemented through the concept of environmental recreation waterfront. The outdoor design includes a recreation area with a playground and children's reading area, a leisure park, a sports park, and a culinary area.
(Udayani and Sumantra 2021)	<i>Pemberdayaan Masyarakat Melalui Diversifikasi Produk Bunga Rosela dalam Mewujudkan Sinergitas Sektor Pertanian dan Pariwisata di Desa Wisata Desa Baha, Mengwi</i>	Agricultural empowerment in Baha Village focuses on the diversification of rosella products, resulting in the development of tourist villages that offer rosella-based products, such as drinks. Rose cultivation attracts tourists who want to know how to plant and harvest the flowers.

In the previous studies (table 1), no one has combined aspects of "urban farming" and "culinary tourism" simultaneously. The combination of the two approaches has the potential to be adapted into uniqueness in formulating the strategy for the development and empowerment of Kampung Surokarsan. Therefore, this study aims to formulate an area development strategy oriented to community empowerment through an analysis of the conditions and mapping of the tourism potential of Kampung Surokarsan. The focus of this study is limited to the formulation of pre-masterplan strategies and initial ideas. SWOT strategy is used because it departs from the reality of strength (S) and weakness (W), which then formulates strategies to respond to Opportunities (O) and Threats (T), which produce practical solutions. The tourism aspect approach covers five aspects (5A) as a solution that accelerates readiness to become a new tourist destination.

Internal and external analysis

SWOT analysis is the identification of various factors to determine the strategy systematically. SWOT analysis must be able to maximize strengths and opportunities but also be able to minimize weaknesses and threats. Therefore,

strategic planning must analyze strategic factors, namely strategies, weaknesses, opportunities, and threats (Rangkuti, n.d.).

Elements of tourism

Related to the goal of achieving readiness to become a new tourist destination, the application of tourism development elements is needed. According to Stange and Brown (1997), the elements of tourism development consist of three (3: attraction, activity, and accessibility). According to Cooper et al. (1995), the tourism component consists of four elements (4: attraction, accessibility, amenity, and ancillary). However, the concept of 4A was then added to the concept of accommodation as a substitution, replacing the concept of ancillary service with 5A (Viktor Bungtilu 2018). The element of tourism development with five main elements was used in this study because it included the required elements. The description of the five main elements of 5A includes the following.

- Attractions: The main components include attraction based on natural, cultural, and artificial wealth.
- Accessibility: Supporting components of the transportation system, including but not limited to road facilities, airports, terminals, and ports.
- Amenities: Supporting components of tourism including but not limited to landfills, restaurants, souvenir shops, and tourist information centres.
- Accommodation: Relating to providing residential facilities as long as tourists are in tourist destinations such as hotels and homestays.
- Activity: This is a component related to providing tourist activities that visitors can do in tourist destinations, such as sports and culinary tourism.

Methods

The method used in this study is the descriptive qualitative method. This method can be described as qualitative research that focuses on the process of happening and the product or result to find out how things happen (Creswell and N. Poth 2016).

Primary data is a source of research data obtained directly from the source. In contrast, secondary data sources are obtained indirectly

through intermediary media (Indriantoro and Supomo 2002). The type of primary data collection in this study was taken from observations, measurements, and interviews with related parties (residents, sub-districts, and stakeholders from related agencies). Then, the secondary data was obtained from a literature review of previous research, sub-district documents, dimensional standard guidelines, and regulations.

This research was conducted in September-November 2023. The flow of research and design development on the empowerment of culinary tourism in Kampung Surokarsan can be seen in figure 1 as follows.

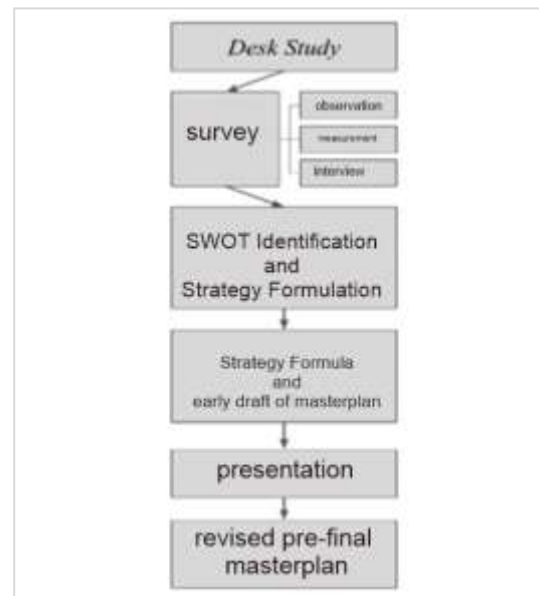

Figure 1. Research and development flow

Results and discussion

1. Internal factors: Strengths and weakness

Kampung Surokarsan has quite a lot of power that can be utilized. The most potential is the existence of the Code Hijau Asri Farmer Group as a community mobilizer and actor (figure 2). Other factors also support this, such as public facilities such as musholla and citizen hall, which are amenities (S2). Furthermore, the variety of culinary businesses owned by residents is also an embryo of the activity element (S3). One of the advantages of Kampung Surokarsan because it is located on the East side of Kali is the potential tourism element of attraction in the form of a

sunset view behind the silhouette of the city village (S5, figure 3). This was conveyed by one of the respondents during an interview to get to know the potential of this area. In more detail, the internal strengths of Kampung Surokarsan are shown by table 2 as follows.

Tabel 2. Strength factor identification results

Internal factors: <i>Strengths</i>	
S1	There is a driving community, the Farmer Group, which already has a management structure and 36 active members.
S2	Several public facilities exist, such as Musholla Nurul Ihsani, and Balai (halls)/PAUD, which can support amenity tourist areas.
S3	Some residents already have culinary businesses, such as grocery stalls, meatballs, drinks, and <i>ramesan</i> .
S4	It is strategically located near the centre of Yogyakarta City, tourist destinations in the Zero Point area of KM-Malioboro, and densely populated settlements.
S5	The view (vista) from the site towards the West in the afternoon is pretty shady and has a <i>sunset view</i> .



(a)



(b)

Figure 2. (a) Active Farmer Group, (b) Existing residents' culinary businesses: grocery, meatballs, processed Brazilian spinach and budimber catfish



Figure 3. The potential of nature is in the form of views of the West from evening until sunset

The river embankment of Kali Code is one of the prominent man-made features in this area. This river embankment, developed in 2016, was

initially the government's response to anticipating the threat of cold lava flows that impacted Kampung Surokarsan (Portal Berita Pemerintah Kota 2016). However, the construction of this river embankment gives the edge of the Kali Code a much better view. The dimensions and facing direction of the space are created, both directly adjacent to the riverbank and the upper side near the settlement has the potential to accommodate local recreational activities in the afternoon (figure 4). Unfortunately, residents of Kampung Surokarsan have not specifically utilized the yard and suburbs of Kali Code, where the conditions are much better for a public area or tourist destination. Its current condition is only as a circulation area equipped with several benches without carefully conceptualized planning.



Figure 4. Bottom side of the Kali Code River embankment

Internal factors are then reviewed, including weaknesses, which are summarized in Table 3. Based on the observation results, most of these weaknesses occur in the accessibility element of the area. Both in terms of the adequacy of space and the visibility/connectedness of access to this area. Currently, on the north and south sides, no markers clarify this area's identity (figure 5, a-b). In addition, other weak tourism elements are related to the availability of parking facilities which facilitate visitors.

Table 3. The weakness factor identification results

Internal factor: <i>Weakness</i>	
W1	Road conditions have enough width for one car circulation. However, they are pretty narrow at some points if used in conjunction with other activities.
W2	There are no road signs to the location from the main road section.
W3	There is no clear marker/identity of the area and entrance gate, making it difficult for outsiders to visit.
W4	It has limited land availability that can be used for new functions.
W5	Most of the area is used for parking lots or warehouses of people's goods.
W6	There are no visitor-only parking lots yet.

Internal factor: Weakness

W7 Farmer's group activities have not been routine, have decreased since COVID-19 and are inefficient if they are self-help.



(a)



(b)



(c)

Figure 5. a) North Entrance, (b) South Entrance, (c) Goods storage and parking

2. External factors: Opportunities and threats

External factors in the form of attractive opportunities are the attention of external parties who have the potential to support the acceleration of the development and empowerment of Kampung Surokarsan. Among others, there is the Kelurahan Wirogunan Masterplan, which includes the branding formulation of Kampung Surokarsan (CV. Dwimatra 2020); the direction of regional identity development has been formulated through several stages of FGD that have led to five formulations (figure 6). The idea of riverfront village tourism is increasingly conducive to a motorbike bridge infrastructure on the south side that presents opportunities for visitor access from the surrounding village. Then, it was also strengthened with gazebos from the environmental structuring of the local

government. More detailed opportunities are summarized in table 4 below.

Table 4. The weakness factor identification results

External factor: Opportunity	
O1	Based on the Masterplan document, Kelurahan Wirogunan already has a branding formulation for Kampung Surokarsan, namely "Kampung Hijau", "Kampung Wisata Tepi Sungai", and "Kampung Mandiri Ekonomi".
O2	Residents often take the motorcycle shortcut on the south side of the bridge/location to get to the main road area around Jogjatronik and Jalan Katamso.
O3	Settlements along the Kali Code are unique portraits of urban village phenomena.
O4	Kelurahan (urban village government) provides support through 8 gazebos.
O5	Potential integration with other tourist attractions is being planned on the banks of the river, which are directly adjacent to the south of the bridge.

Table 5. Village Branding formulation

Branding of Surokarsan Village based on FGD2		
Environmentally & Health-Conscious Village		
1	Environmentally Friendly Village	
2	Fruit Village	
3	Riverside Tourism Village	1 Green Village
4	Healthy Green Village	
5	Clean Village	
6	Beautiful Village	2 Healthy Village
7	Sports Village	
Social & Cultural Awareness Village		
8	Safe Village	Livable
9	Prosperous Village	3 Prosperous Village
10	Child-Friendly Village	
11	Art Village	4 Arts and Culture Village
Economically and Technologically Advanced Village		
12	Community Economic Independence Village	5 Economically Independent Village
13	Fisheries Village	
14	Agrotourism Village	

Source: (CV. Dwimatra 2020)

Table 6 shows the external factors that threaten (threats) found in Kampung Surokarsan. The arrangement of riverside areas is very dependent on the policies of their respective local governments. It is known from the FGD stakeholders that the Mundur (Retreat), Munggah (Upwards), Madhep (Facing) the river (M3K) policy on the West side of Kali Code may not be equivalent to its progress compared to the Kampung Surokarsan RW 04 area. The image of the slum is still relatively visible from the East to the West side because of pigeon cages and piles of goods and sometimes garbage on the riverbank.

This situation is less conducive to the development of culinary tourism that is being prepared.

Table 6. Threat factor identification results

External factors: <i>threats</i>	
T1	It is prone to a stigmatized image of riverside settlements that are seen as slums by the public.
T2	Tourist attractions have not been well-socialized and have not attracted prospective visitors.
T3	It is not easy to access the location by public transportation, and it is far from where visitors can go on foot.
T4	Regulations on river boundaries and evacuation routes must be considered despite the risk of limiting design exploration.

3. Formulation of design strategies on the five elements of tourism

Based on the IFAS and EFAS matrix, the design strategy for the five elements of tourism (5A) is formulated. Table 7 shows the SO Strategy, which utilizes the potential to take advantage of opportunities as much as possible. The WO strategy responds to existing opportunities by minimizing weaknesses in the organization, also known as the turn-around strategy (Istiqomah and Andriyanto 2018). The ST and WT strategies address threats by maximizing excess and minimizing deficiencies, as shown in table 8.

Table 7. IFAS strategy matrix on opportunities

	SO Strategy	WO Strategy
OPPORTUNITY	<p><i>Attraction</i></p> <p>Wisata Tepi Sungai and "Kampung Hijau" are held on an ongoing basis, and promotions are supported by citizens, the government, and the private sector (S1, O1) "nyore" (It is an afternoon activity to relax and enjoy the time after activities and unwind in the afternoon) tour and relax with sunset view and city village atmosphere (S5, O3)</p>	<p>We are presenting <i>vocal points</i> in the river embankment area as an area attraction with non-permanent construction techniques, such as bamboo and mural installations (W2, 4, O2).</p>
	<p><i>Activity</i></p> <p>Presenting recreational activities that visitors can do, such as:</p> <ul style="list-style-type: none"> • Culinary tour (S3, O5) • Vegetable picking tour package (S1, O2) • <i>Selfie spot</i> (S5, O2) • <i>Workshop: urban farming</i>, food processing, <i>sustainable lifestyle</i> (S1, O5) 	<p>Organize scheduled activities/ urban-farming-based tour packages promoted to other related parties and tourist destinations (investors, governments, citizens and the private sector) (W7, O1).</p>

	SO Strategy	WO Strategy
THREATS	<p><i>Accessibility</i></p> <p>Redesign the entrance to the Kampung Kuliner area by adding:</p> <ul style="list-style-type: none"> • Gate: to invite visitors' attention from crowded areas around the site. (W3, O2) • Car and motorcycle parking area at both ends of the entrance (W6, O2) 	<p>Establish <i>signage</i> design: to improve the clarity of the unifying identity of the region by applying consistent visual brandings such as colour, texture, and material. (W3, O1).</p>
	<p><i>Amenity</i></p> <p>Maximizing the gazebo for culinary seating filled by nearby residents (S3, O4) Utilizing <i>existing</i> public facilities (prayer rooms and halls) to support the comfort of visitors (S2, O1)</p>	<p>Design alternative <i>portable</i> kiosk designs to suit limited land and types of food sold. (W1, W4, O1).</p>
	<p><i>Accommodation</i></p> <p>Conducting evaluations and assessments of the feasibility of residents' homes as lodging accommodation providers (W4, O3)</p>	<p>Using <i>influencer</i> promotion media, holding workshops or similar arts (for example, as a <i>Venue Biennale</i>). (W7, O3).</p>

Table 8. EFAS strategy matrix against threats

	ST Strategy	WT Strategy
THREATS	<p><i>Attraction</i></p> <p>Create unique activities that make a difference with similar tourism elsewhere.</p>	<p>Tourist attractions generally have many similarities with other villages. Exploring the unique potential of the Hijau Asri Code Farmers Group is required to attract more visitors.</p>
	<p><i>Activity</i></p> <p>Activities in Urban Farming of Kampung Kuliner are generally only crowded in the afternoon. This is a threat to tourists' activities in this area. The strategy is scheduled and programmed activities.</p>	<p>-</p>
	<p><i>Accessibility</i></p> <p>-</p>	<p>Improvement of the supporting <i>street furniture</i>, such as seating and gazebos, is needed.</p>
	<p><i>Amenity</i></p> <p>A more organized storage area is needed.</p>	<p>Training in Human Resources to welcome domestic and foreign tourists is required.</p>

	ST Strategy	WT Strategy
Accommodation	The locals may set up the houses in the village as guest houses or coffee stalls with infrastructure improvements, improvements in the buildings' visuals, and improvements in the surrounding environment.	-

4. Pre-masterplan design ideas

The location of culinary tourism development is set along the village road that *Poskamling* (neighbourhood security post) of Gang Nangka bounds on the North side and Bendung Mergangsan Bridge on the South side. The structuring concept divides the area into four activity zones connected by the Gang Nangka corridor (figure 6). The proposed ideas are structuring the north and south gates, photo spot design, culinary kiosk design, and educational workshop area design (figure 7).

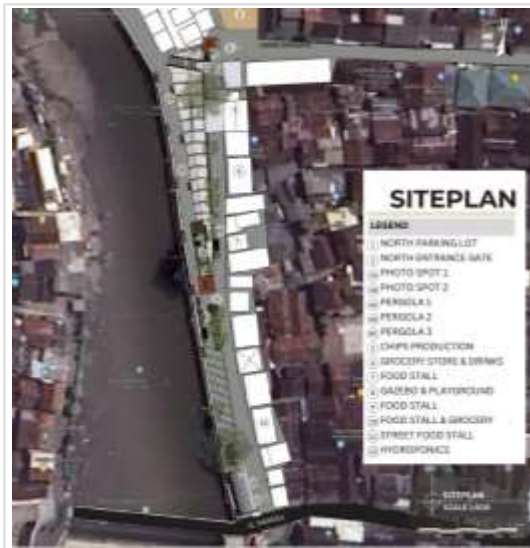

Figure 6. Pre-masterplan document: Siteplan

Structuring the entrance gate

Access to the RW 04 area is not directly related to the main road; currently, it only looks like a small road, even though it is crowded with residents. Therefore, a marker is needed at the entrance points to confirm the area's identity. Figure 8 shows the design of the North Entrance gate, which is streamlined to only include the text and background of the area marker, given the limited area at this intersection. However, the

South gate is more extensive and integrated with the *angkringan* and sitting area because of the dimensions of the possible area (figure 9). This function responds to its proximity to the motorcycle shortcuts to the crowded residential areas behind Jogjatronik and sunset views on Instagrammable river water reflections in the afternoon.

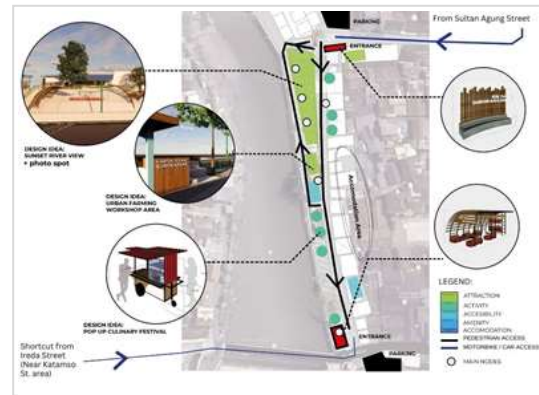

Figure 7. Zoning ideas space programs



Figure 8. Signage design for the north entrance

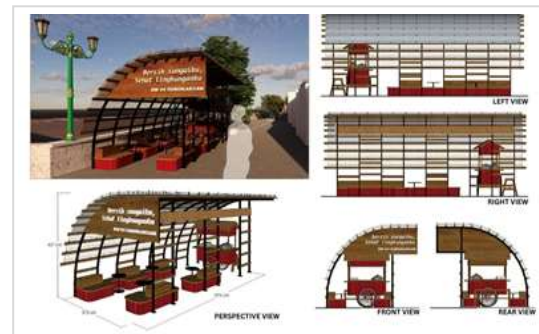

Figure 9. South gate and sitting area details

Designing the photo spot

The north side of the Kampung Surokarsan RW 04 area can be divided into two areas due to the differences in the contours: the upper area

(settlement) and the lower area (riverbank). The arrangement of this lower zone responds to the afternoon view of the west side and the orientation towards development that leads to the river. This area arose due to the construction of the river river embankment. The existing function consists of seating, stairs from the upper residential area and road access. From the interview, it is known that this road is allocated as emergency access, so it should not be blocked. However, it can only be passed by a motorbike. The Spatial Planning Office also confirms that the riverfront of the river embankment area cannot be built as a permanent building, even though the area here is extensive and dominating. Therefore, the proposed design must take these factors into account.

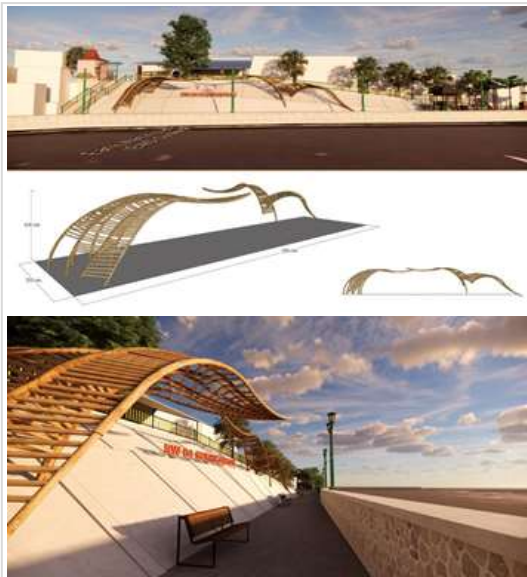

Figure 10. Overview of photo spot design

The proposed function for this area is as a photo spot, considering that the photo activities are still in line with the concept of Kampung Kuliner. The design of this area is proposed to use the installation of murals so that when the visitors take pictures, it can be a free word-of-mouth promotion opportunity. In addition, installing a bamboo structure becomes an attractive object for photography and also meets the criteria of a non-permanent structure (figure 10).

The massive river embankments can be made less tedious and more enjoyable with murals. Moreover, the river embankment facing the river is very visible from the bridge shortcut on the south side, which is heavily trafficked by motorcycles, so it has the potential to become an

icon of the area. It would be a waste to miss it. The mural can also be used as a thematic and periodic agenda that becomes a medium for 5K collaboration, namely City, Corporation, Community, Village and Campus. The Kelurahan also welcomes this design proposal because it follows the vision of the Mundur, Munggah, Madhep Kali (M3K) arrangement policy, which gives the river an orientation towards the building. With this provision, the cleanliness and sustainability of the river are maintained by setting a sufficient distance, and the riverfront is not the back area of the building that has not cared about its look.

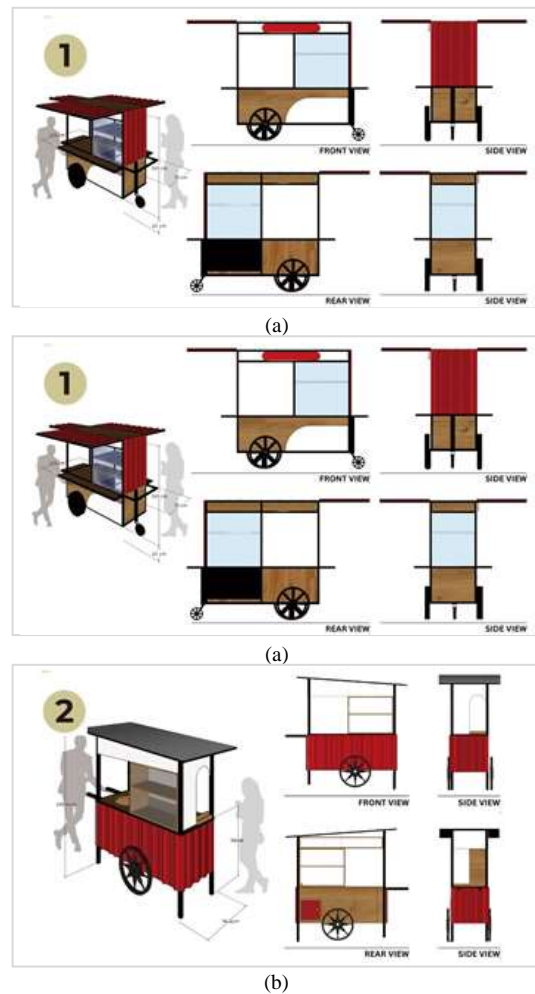

Figure 11. Cart design alternatives: (a) large cart type, (b) medium cart type

Culinary Kiosk design

The proposed kiosk design is made in the form of 4 different models (figure 11). The lack of space available in this informal settlement makes

the design criteria unique. Based on observations and interviews, the design must be adaptive because the area is not ideal, responding to the many variations in the types of food sold, but at the same time, there is also a need for a similar visual character to form the identity of the area at least in the main culinary tourism section. Therefore, a consistent colour scheme is used: red, black and white. Spandek Galvalum 0.3 SNI painted red duco dominated the material that coated the broad surface.

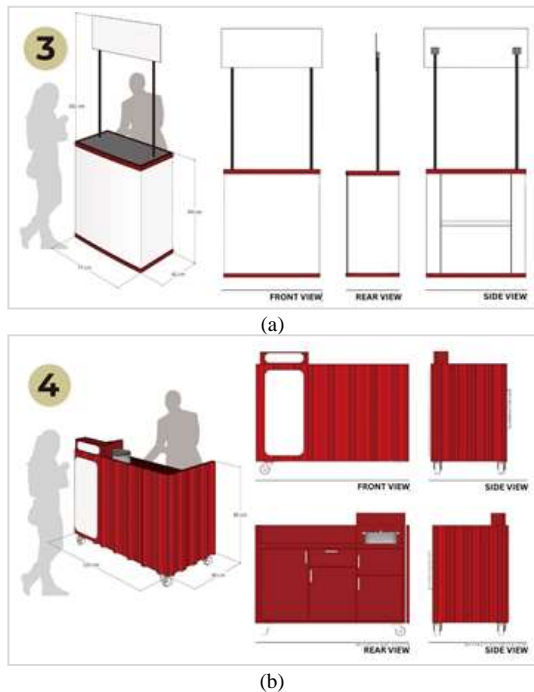

Figure 12. Alternative booths (a) and portable tables (b)

Farmers group members recently also received urban-farming equipment facilities combined with a catfish cultivation system in a bucket (known as *budimber*). The follow-up of the program also included food processing training based on the two commodities produced, namely Brazilian spinach and catfish. Therefore, there are designs aimed at selling frozen preparations such as catfish nuggets, spinach sticks, and spinach chips (Booth Portable, figure 12). However, some types respond to the sales of residents who have been running for a while. For example, the Portable Table Type that suits residents who sell seblak, can be moved or converted because these residents only have a small area and sell only a few hours in the

afternoon. Lastly, a Large Cart Type can be moved to several gazebo areas donated by the local government, allowing pop-up stands for food types such as meatball sellers and *angkringan*.

Educational workshop area design

Currently, the green open space in the form of children's playgrounds, gazebos, and adjacent *poskamling* (neighbourhood security posts) is often used for residents to store goods and park motorbikes. It has the potential to disrupt visual quality. Therefore, this design proposes a workshop area as a mini amphitheatre area, aiming to support knowledge-sharing activities towards educational tourism as part of culinary tourism activities (figure 13). Residents of RW 04, especially those trained and have practised urban farming and *budimber* (catfish farming in buckets), can create a training program that is made into a periodic agenda. This educational program can also become an alternative income that empowers the community.



Figure 13. Educational workshop area design ideas

Conclusions

The strategy of structuring the culinary tourism area of Kampung Surokarsan can be mapped by adapting the 5A element approach, namely Attractions, Accessibility, Amenities,

Accommodation, and Activities. The details are as follows: (1) Elements of strategic attractions are riverside tours (*Wisata Tepi Kali*), Kampung Hijau, and "nyore," and relaxing with sunset views completed by a village atmosphere. They are equipped with a vocal point for installing bamboo and murals; (2) The elements of recreational activities that can be presented are culinary tours, vegetable picking tour packages, selfie spots, and periodically scheduled agendas such as workshops and urban farming tours, food processing, and sustainable lifestyle; (3) Redesigning entry, landmarks, parking, and signage enhance accessibility elements; (4) The amenities element is enhanced by maximizing the function of the gazebo, musholla, and meeting hall and by designing alternative portable kiosk designs to suit limited land and types of food; (5) The Accommodation element can be developed by exploring people's homes for guest houses or coffee shops.

Overall, the area development can be categorized into four activity zones along the Gang Nangka corridor. The proposed ideas are: (1) arrangement of the north and south gates; (2) photo spot design; (3) culinary kiosk design intervention; and (4) arrangement of educational workshop area. The structuring of organically grown residential areas such as Kampung Surokarsan is constrained by unideal space and conditions. The creative side of architecture is needed to produce an adaptive and versatile design.

References

- Cooper, Chris, John Fletcher, David Gilbert, dan Stephen Wanhill. 1995. *Tourism, Principles, and Practice*. Second. Harlow: Prentice Hall.
- Creswell, John W., dan Cheryl N. Poth. 2016. *Qualitative Inquiry and Research Design: Choosing among Five Approaches*. Fourth Edition. Los Angeles: Sage Publications.
- CV. Dwimatra. 2020. "Masterplan Kelurahan Karangwaru: Perencanaan Kawasan Terintegrasi." Yogyakarta.
- Ervianto, Wulfram I., dan Sushardjanti Felasari. 2019. "Pengelolaan Permukiman Kumuh Berkelanjutan di Perkotaan." *Jurnal Spektran* 7: 178–86.
- Hasibuan, Friska, Fermanto Lianto, Samsu Hendra Siwi, and Martinus Bambang Susetyarto. 2021. 'Utilization of Public Open Space in Kampung Deret Petogogan Jakarta'. *ARTEKS: Jurnal Teknik Arsitektur* 6 (2): 189–98.
<https://doi.org/10.30822/arteks.v6i2.654>.
- Indriantoro, Nur, dan Bambang Supomo. 2002. *Metodologi Penelitian Bisnis*. 1 ed. Yogyakarta: BPFE-Yogyakarta.
- Istiqomah, Istiqomah, and Irsad Andriyanto. 2018. 'Analisis SWOT Dalam Pengembangan Bisnis (Studi Pada Sentra Jenang Di Desa Kaliputu Kudus)'. *BISNIS : Jurnal Bisnis Dan Manajemen Islam* 5 (2): 363–82.
<https://doi.org/10.21043/BISNIS.V5I2.3019>.
- Khansyah, Rifqi. 2024. 'Housing and Settlements in The Ujung Menteng Urban Village Area'. *Journal of Architecture and Human Experience* 2 (1): 23–38.
<https://doi.org/10.59810/archimane.v2i1.41>.
- Kusumosusanto, J. Wahyu, Valentina, Winda Laksana, Haris Pujogiri, Aris M. Budiawan, Eko Priantono, Roofy Reizkapuni, dkk. 2022. *Buku Saku Identifikasi dan Penilaian Lokasi Kumuh*. Kementerian Pekerjaan Umum dan Perumahan Rakyat.
- Mahagarmitha, Rilia Riggins. 2018. 'Community Participation in The Development of Kampung Warna-Warni Teluk Seribu In Balikpapan City'. *ARTEKS: Jurnal Teknik Arsitektur* 3 (1): 57–70.
<https://doi.org/10.30822/arteks.v3i1.54>.
- Portal Berita Pemerintah Kota Yogyakarta. 2016. 'Pembangunan River embankment Selesai, Warga RW 04 Surokarsan Gelar Syukuran'. 2016.
<https://warta.jogjakota.go.id/detail/index/4979>.
- Rangkuti, Freddy. t.t. "Teknik Membedah Kasus Bisnis Analisis SWOT." Jakarta.
- Resa, Ade Masya, Zulfan Saam, dan Suardi Tarumun. 2017. "Strategi Penataan Kawasan Permukiman Kumuh Perkotaan Kampung Bandar Kota Pekanbaru." *Jurnal Dinamika Lingkungan Indonesia* 2: 117–27.
- Sekretaris Daerah Kota Yogyakarta. 2021. 'Keputusan Walikota Yogyakarta Nomor 158 Tahun 2021 Tentang Penetapan Lokasi Perumahan Kumuh Dan Permukiman Kumuh'.
https://hukum.jogjakota.go.id/index.php/result/download_file/lqmSnA70k3R3D70k3R3D.
- Stange, Jennifer, dan David Brown. 1997. *Tourism Destination Management: Achieving Sustainable and Competitive Results*.

- Washington: The George Washington University.
<http://lms.rmpportal.net/course/category.php?id=51>.
- Sulistyaningsih, Dwi, dan Ira Mentayani. 2022. "PENATAAN KAWASAN TEPIAN SUNGAI SEBAGAI RUANG TERBUKA DI MURUNG KENANGA, MARTAPURA." *Jurnal Lanting* 10 (Februari).
- Tyas, Hari Saptaning. 2023. "LAPORAN KEMAJUAN PEMBERDAYAAN KEMITRAAN MASYARAKAT." Yogyakarta.
- Udayani, Ni Nyoman Wahyu, dan I Ketut Sumantra. 2021. "PEMBERDAYAAN MASYARAKAT MELALUI DIVERSIFIKASI PRODUK BUNGA ROSELLA DALAM MEWUJUDKAN SINERGITAS SEKTOR PERTANIAN DAN PARIWISATA DI DESA WISATA DESA BAHA, MENGWI." *Jurnal Pengabdian Masyarakat Abditani*.
- Ulwiyyah, Shintia. 2023. 'Perancangan Kawasan Pusat Seni Ukir Kayu Kota Jepara'. *Journal of Architecture and Human Experience* 1 (1): 53–60.
<https://doi.org/10.59810/archimane.v1i1.5>.
- Viktor Bungtilu, Laiskodat. 2018. *Pariwisata Nusa Tenggara Timur: Potensi dan Dinamika*. Salatiga: Satya Wacana Univerity Press.
- Wulandari, Anis, and Ramos Pasaribu. 2023. 'Evaluasi Kualitas Lingkungan Dengan Pendekatan Arsitektur Ekologis Pada Rusunawa Klender'. *Local Engineering* 1 (1): 21–30.
<https://doi.org/10.59810/lejlace.v1i1.30>.
- Zahran, Rafif Adimas, dan Tantan Hermansah. 2022. "PEMBERDAYAAN MASYARAKAT DI KAMPUNG WISATA BEKELIR KELURAHAN BABAKAN KECAMATAN TANGERANG KOTA TANGERANG." *Jurnal Pengembangan Masyarakat Islam* 1 (1): 17–27.

Author(s) contribution

Mutiara Cininta contributed to the research concepts preparation, methodologies, investigations, data analysis, visualization, articles drafting and revisions.

Hari Saptaning Tyas contribute to the research concepts preparation and literature reviews, data analysis, of article drafts preparation and validation.

This page is intentionally left blank